



Customer Service

UK Freephone: 0800 521 050
UK Freefax: 0800 521 205
Eire Tel: 01 4620739
Eire Fax: 01 4620745
Email: cservice@knauf.co.uk

Technical Service

UK Tel: 01795 416 259
Eire Tel: 01 4620739
Email: technical@knauf.co.uk

Literature

UK Tel: 08700 613 700
Eire Tel: +44 8700 613 700

Website

www.knauf.co.uk
www.knauf.ie

Knauf
Kemsley Fields Business Park
Sittingbourne
Kent ME9 8SR

Knauf
87 Broomhill Road
Tallaght
Dublin 24

Knauf Factory Locations

Ridham Dock
Sittingbourne
Kent

Queens Road
Immingham
N.E. Lincolnshire



Dry floor screed panels

Easy to install

Environmentally friendly

Impressive acoustic performance

Excellent thermal conductivity

High recycled content

**Site Installation Guide for
Knauf Brio Flooring Systems**

Exceptional performance and on-site benefits

© Copyright Knauf 2015

The information given in this publication is believed to be current and accurate as at the date of publication, but no warranty, express or implied is given. Updates will not be automatically issued.



Build for the world we live in

Knauf Brio dry screed floor boards

Improved acoustic performance and underfloor heating efficiency

Knauf Brio is an engineered gypsum flooring panel with 60% recycled content. It is specially developed for use in new or refurbished residential and commercial buildings. Knauf Brio is a strong, lightweight and quickly-installed dry screed system.

It has a very high thermal conductivity ($R = 0.38 \text{ W/mK}$) so heating response times are quicker than with traditional floor systems and energy use is reduced. Once installed, Brio creates a robust monolithic floor with a high density of 1100 Kg/m^3 , and so reduces impact and airborne sound transmission. With a wholly dry installation process, Brio maximises on-site efficiency too. And it's backed by Knauf's unrivalled service and support.

KEY BENEFITS ON-SITE

Requires no water or wet trades

Quick and easy installation – no specialist trades required

Can be installed and ready for traffic within hours

No drying time means no delays

Minimal material wastage

Better health and safety on site

Cuts vehicle movements on site

Reduces the cement content of the building

Reduces load on tower blocks, which can cut foundation and steelwork requirements

Knauf Brio is quick and easy to install

Knauf Brio does not require additional specialist trades on site; installation is well within the capabilities of a competent tradesperson. Each panel is manufactured with precision, so that boards fit together smoothly and quickly.

The dry installation process minimises delays on site and adds flexibility to build schedules. Drying times on site are eliminated, as is the additional moisture in the building fabric that comes with wet screeds.

There are none of the trip hazards associated with bulky batten and chipboard systems. Panel joints are simply glued together and fastened with Knauf Brio Screws, designed to stop exactly 1 mm short of the bottom of the precision-engineered panel.

The result – every time – is a solid, high quality, level floor that is ready for a wide variety of finishes – and traffic – within hours.

Over underfloor heating

Maximises the thermal efficiency of underfloor heating

Low profile underfloor heating system installation

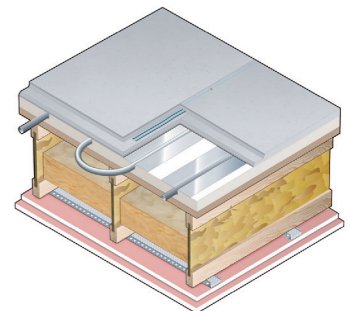

Dry application

Completely dry installation

Can be trafficked within 4 hours

No compromise to floor coatings

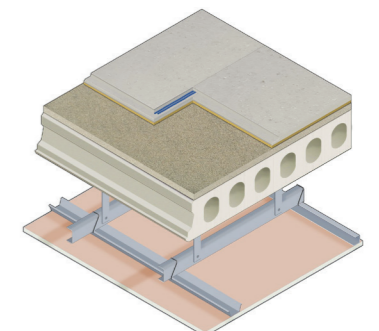

Acoustic solutions

Removes need for acoustic battens

Perfect for upgrading existing floors

Provides acoustic solutions for Part E and to achieve BREEAM ratings

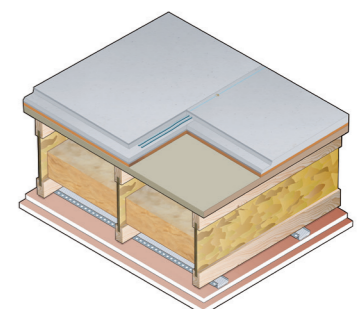

Site installation guide for Knauf Brio Systems



1 Ensure the substrate is clean and dry.



2 Measure the area.



3 Place the edge strip up against the perimeter.

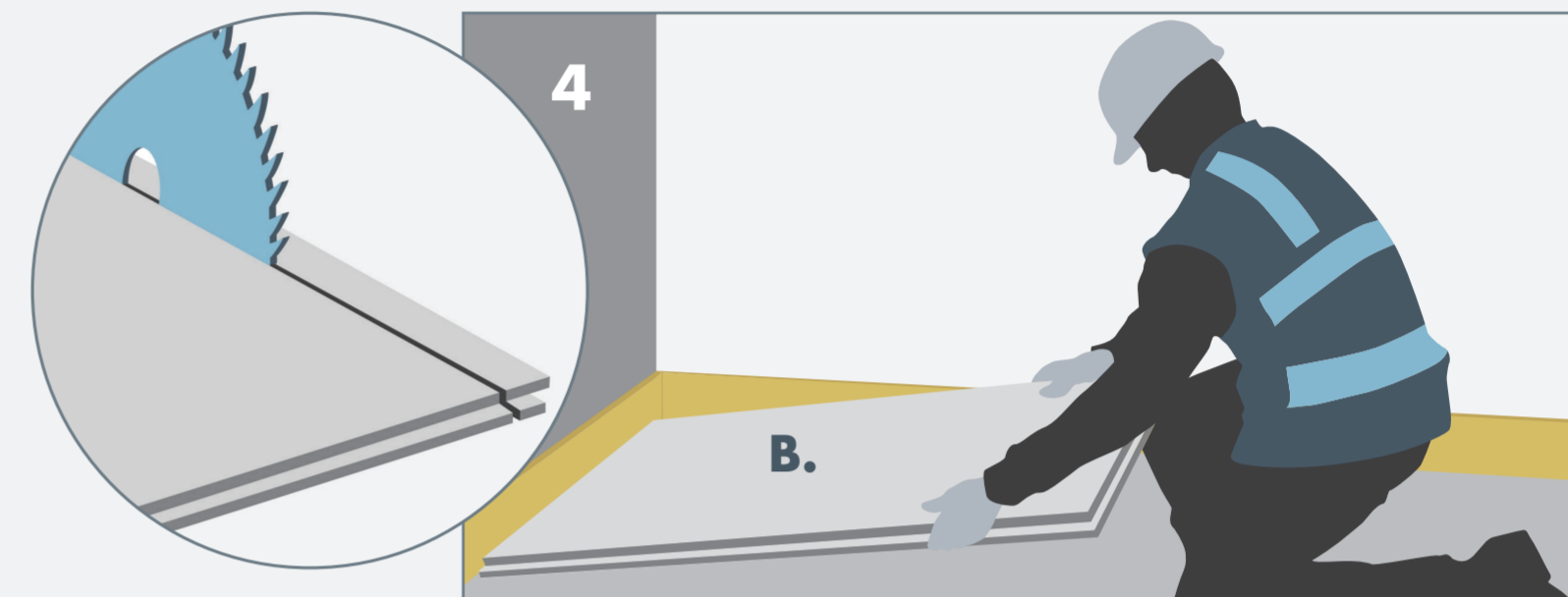

4 After the edges are cut away, lay the first board in a corner, from left to right.

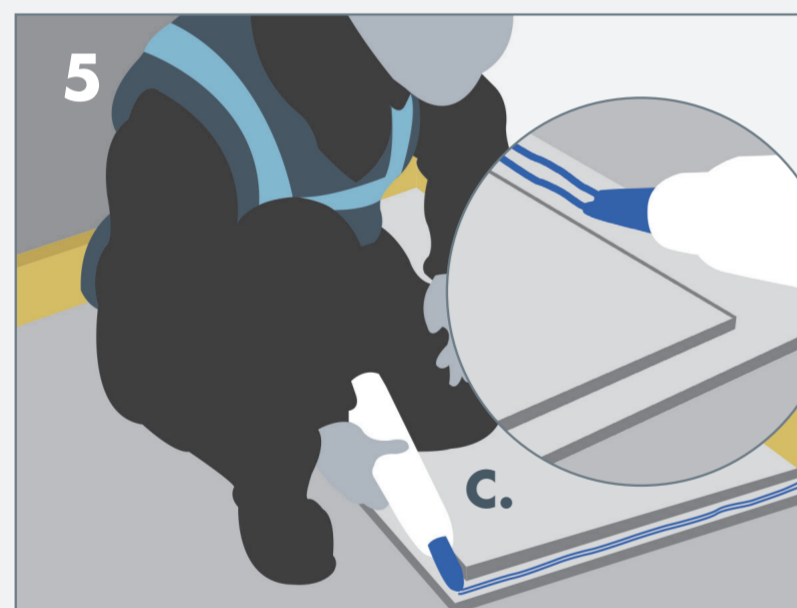

5 Adhesive is easily applied with one simple movement using the blue nozzle.



6 Lay the tiered edge of the next board onto the twin bead of adhesive.

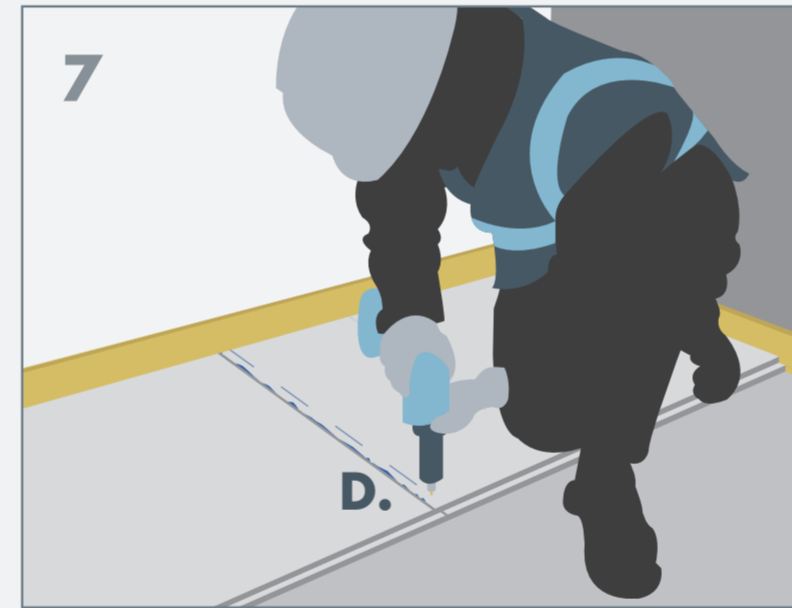

7 Boards come printed with a blue screw line.



8 Cut off from first row starts the next (minimum 200mm overlap).

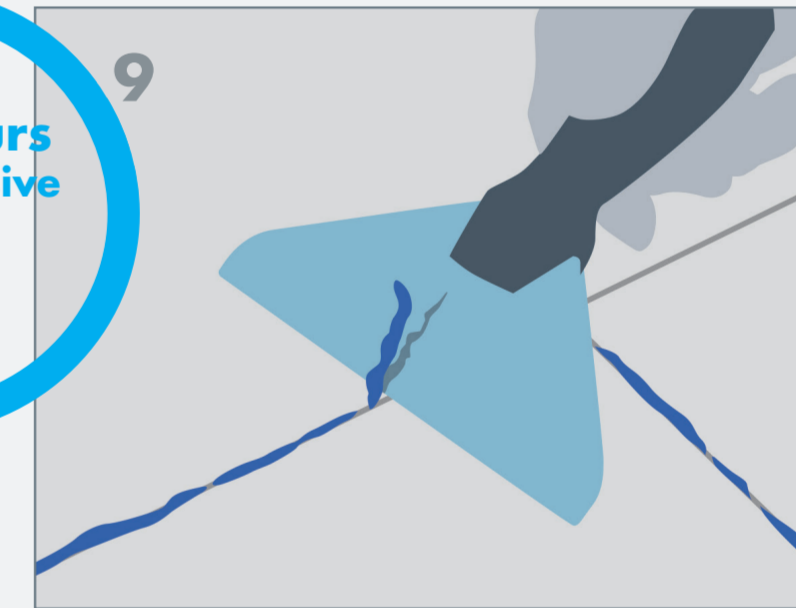

9 Remove excess adhesive with a floor scraper.

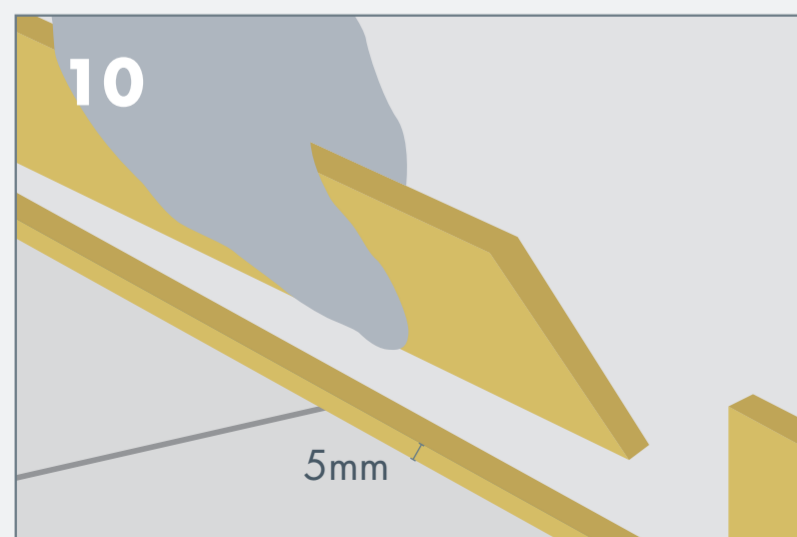

10 Remove excess edge strip leaving a 5mm upstand.



11 Once the floor is laid and clean, apply Knauf Floor Primer prior to adhering any floor finish. For vinyl floor finishes always apply a suitable self-leveller.

Required accessories

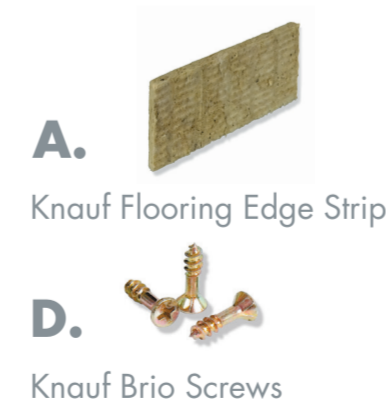

A. Knauf Flooring Edge Strip



D. Knauf Brio Screws



C. Knauf Brio Joint Adhesive



E. Knauf Schnellgrund Floor Primer

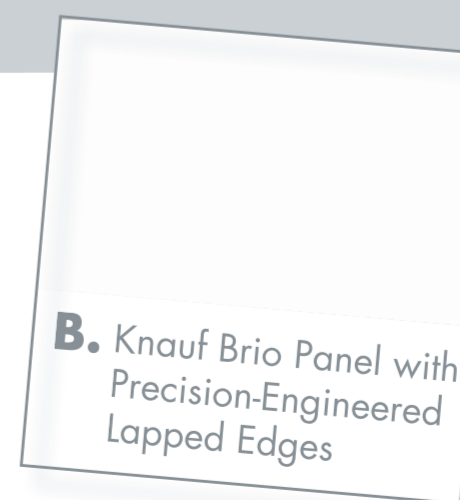

B. Knauf Brio Panel with Precision-Engineered Lapped Edges

Please contact us for further installation advice

- Levelling and overcoming uneven surfaces
- Movement joint detailing
- Door thresholds
- Slopes and steps
- Mechanical fixing into Brio
- Acoustic solutions
- Underfloor heating solutions